

AUBO-i20

i Series Collaborative Robot

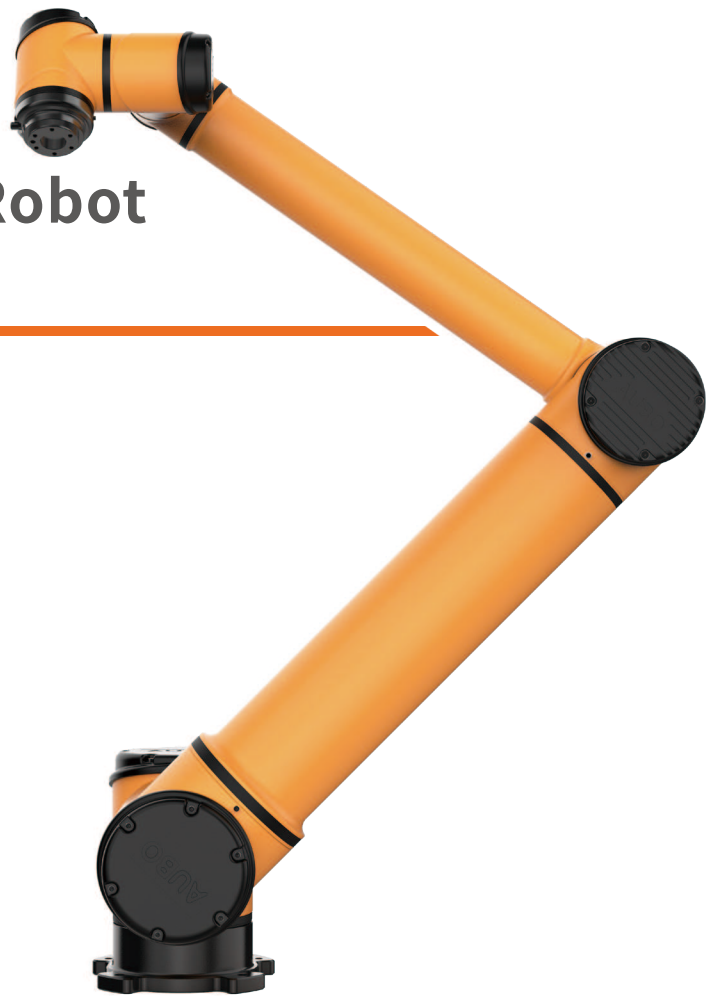

20KG

PAYLOAD



63.7KG

WEIGHT



±0.05mm

REPEATABILITY



1650mm

WORKING RADIUS

- ✓ Payload: 20kg | Joint Rotation: ±360°
- ✓ Max Working Radius: 1650mm | Repeatability: ±0.05mm
- ✓ Highlight: 1:3 payload-to-weight ratio, ideal for various heavy-duty applications.

Applications

3C, Automotive, New Energy, Semiconductors, Machining, Hardware & Appliances, Kitchen/Bath, Healthcare, Research & Education, F&B (Food & Beverage), New Retail, Daily Chemicals, Logistics.



CERTIFICATIONS

- ISO 13849(PL d with Cat. 3)
- CE Certification
- NRTL Certification
- KCs Certification
- CR Certification
- SEMI S2 Certification
- RoHS Certification
- ISO class 4 Cleanroom ISO Class 4



Features & Advantages

(Compared to the previous generation of products)

- 01 Heavy Payload & High Precision:**
20kg payload, 1650mm reach, ±0.05mm repeatability, and a 1:3 payload-to-weight ratio.
- 02 Safe Collaboration:**
Supports force sensors for collision detection and drag-to-teach.
- 03 Intuitive Operation:**
Visual interface; master programming in 30 minutes.
- 04 Open System:**
Supports SDK/API and diverse protocols for seamless integration with grippers, vision, and mobile peripherals.



High Performance



High Precision



Rapid Response



Safe and Stable



Flexible Production



Fine Craftsmanship



Compact and Lightweight



Modular Design



High Protection Class



...

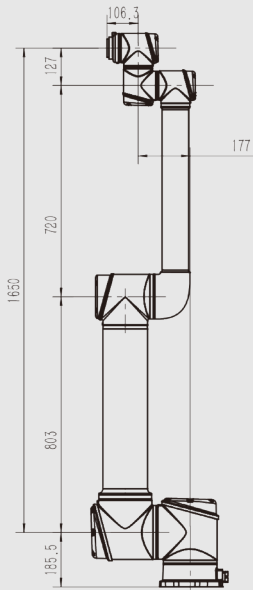

AUBO-i20 Dimensions Diagram

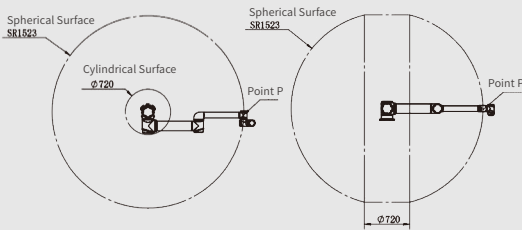

AUBO-i20 Point P Motion Range

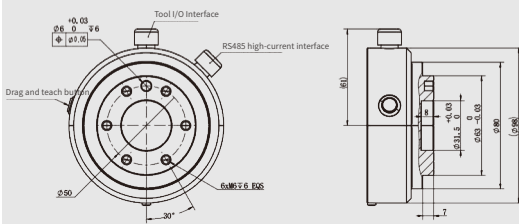

AUBO-i20 End Flange

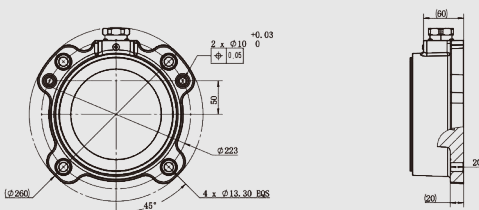

AUBO-i20 Base Top View

Robot

Degrees of Freedom	6
Max Working Radius (mm)	1650
Payload (kg)	20
Weight (kg)	63.7
Footprint Diameter (mm)	Ø260
Repeatability (mm)	±0.05
Tool Speed (m/s)	≤2.6
Average Power (W)	1000
Peak Power (W)	3000
Operating Temp. Range (°C)	0-50
Operating Humidity	90% RH (Non-condensing)
Mounting	Any angle
IP Classification	IP54

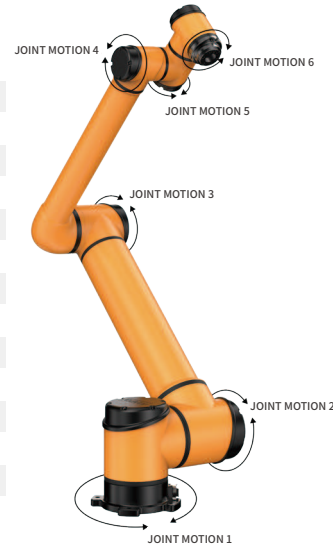

Joint Motion	Range of Motion(°)	Max Speed (°/s)
joint 1	±360	110
joint 2	±360	110
joint 3	±168	178
joint 4	±360	178
joint 5	±360	178
joint 6	±360	178

* Joint motion capabilities may be limited by application scenarios; maximum speeds may not be reached. Please note this during use.

Control Cabinet

Product Model	AUBO-CB-IS
Dimensions (L*H*W)	400mm*320mm*160mm
Weight	12.5kg
Robot Arm Cable Length	5m (Customizable, up to 8m)
Teach Pendant Cable Length	4m
Power Cable Length	5m
Communication Protocols	Ethernet, ModBus-RTU/TCP, Profinet, Ethernet/IP (Optional)
Interfaces & Openness	SDK (C/C++/C#/Lua/Python/JavaScript Windows + Linux) , supporting ROS/ROS2, AP
Power Supply	115/230VAC, 50/60Hz
IP Classification	IP43



I/O Interfaces	Control Cabinet	Tool End	
I/O Interfaces	Digital Input	16(Standard),16(Configurable)/8(Safety)	4 (Configurable)
	Digital Output	16(Standard),16(Configurable)/8(Safety)	4 (Configurable)
	Analog Input	2	2
	Analog Output	2	-
	RS485 Communication	2	1 (Configurable)
I/O Power	Output Voltage	24V	0V/12V/24V
	Output Current	3A Max	2A (3A Max)

Teach Pendant

Product Model	AUBO-TP-IS
Dimensions (L*H*W)	254mm*213.1mm*40.8mm
Weight	1.0kg
IP Classification	IP54
Color	Orange + Black



Disclaimer

1. The content of this product datasheet is subject to change without prior notice.
2. This product datasheet is the intellectual property of our company, and all rights are reserved. Any reproduction or citation of the content must indicate the source. Unauthorized reproduction is strictly prohibited; violators will be considered infringing and will be held legally liable in accordance with the law.

